

Administration fee: 10€ (administration fee are never refunded)

Payment of stay:

Your reservation is only valid after receipt of your signed reservation contract, payment of deposit and administration fee and after you have received our confirmation letter.

Remainder of the total rent:

The remainder is to be paid at least 30 days before your arrival. In case of non-payment of the remainder 30 days before arrival, the heading "cancellation" will come into effect.

Caution: Beyond this time limit, if we have not received your payment, your reservation will be cancelled and the following terms (of cancellation) will apply.

Late arrival or early departure:

Pitch: full payment of the reserved stay has to be paid in case of late arrival or early departure.

Rental accommodation: no refund in case of delayed arrival or early leaving.

We will keep the pitch or one rental accommodation for 48 hours from your date of arrival. After this period, we will use it.

Cancellation:

By "*La Vallée de Gardeleau*": in case of cancellation for reasons of absolute necessity, leading us to cancel. The customer will be refunded the totality of the payment.

By camper:

Pitch:

- If the cancellation is made more than 30 days before arrival, we will keep the administration fee (10€).

- If the cancellation is made less than 30 days before arrival, we will keep the deposit.

Rental accommodation:

- If the cancellation is made more than 30 days before arrival, we will keep the deposit.

We strongly advise you to take out a cancellation insurance!

Insurances; it's up to you to insure yourself...

Guarantee:

For a "rental accommodation", on your arrival, we will ask for a deposit of: 300€. This guarantee includes material damage and housecleaning on your departure.

If your accommodation is not clean, we will keep 50€ for housecleaning.

All customers are required to conform to the rules of the campsite

Administration fee: 10€ (administration fee are never refunded)

Payment of stay:

Your reservation is only valid after receipt of your signed reservation contract, payment of deposit and administration fee and after you have received our confirmation letter.

Remainder of the total rent:

The remainder is to be paid at least 30 days before your arrival. In case of non-payment of the remainder 30 days before arrival, the heading "cancellation" will come into effect.

Caution: Beyond this time limit, if we have not received your payment, your reservation will be cancelled and the following terms (of cancellation) will apply.

Late arrival or early departure:

Pitch: full payment of the reserved stay has to be paid in case of late arrival or early departure.

Rental accommodation: no refund in case of delayed arrival or early leaving.

We will keep the pitch or one rental accommodation for 48 hours from your date of arrival. After this period, we will use it.

Cancellation:

By "*La Vallée de Gardeleau*": in case of cancellation for reasons of absolute necessity, leading us to cancel. The customer will be refunded the totality of the payment.

By camper:

Pitch:

- If the cancellation is made more than 30 days before arrival, we will keep the administration fee (10€).

- If the cancellation is made less than 30 days before arrival, we will keep the deposit.

Rental accommodation:

- If the cancellation is made more than 30 days before arrival, we will keep the deposit.

We strongly advise you to take out a cancellation insurance!

Insurances; it's up to you to insure yourself...

Guarantee:

For a "rental accommodation", on your arrival, we will ask for a deposit of: 300€. This guarantee includes material damage and housecleaning on your departure.

If your accommodation is not clean, we will keep 50€ for housecleaning.

All customers are required to conform to the rules of the campsite



Dear Madam, Sir,

Thank you for taking an interest in our region and coming to our campsite.

At the gate of the Périgord region "*La Vallée de Gardeleau*" welcomes you for ideal family holidays.

"La Vallée de Gardeleau" has 35 pitches set in shady woodland surrounded by 2 hectares of peaceful countryside.

You will discover "*La Vallée de Gardeleau*" in the midst of a region of woodland and vales, rich with places of interest and beautiful landscapes.

You can practise fishing in ponds, cycling, mountain biking, country walking and many other activities...

"*La Vallée de Gardeleau*" has a swimming pool, a children's playground, a volleyball ground, a mini golf, a petanque track, a table football and table tennis.

The campsite has a bar and a restaurant.

We are looking forward to see you soon.

Laurent FAIVRE

47410 SERIGNAC-PEBOUDOU - ☎-Fax :+33 (0)5 .53 36 96 96

E-mail: valleegardeleau@wanadoo.fr

Site: <http://camping-valleegardeleau.com>

SARL VPLF

"La Vallée de Gardeleau"

RCS Agen 498460476 Siret 49846047600019 - APE 552 C
Arrêté préfectoral n°96-1788 du 29 juillet 1996

RATES 2013 T.T.C in EUROS

EQUIPPED RENTAL ACCOMMODATION

RESERVATION CONTRACT 2013

PITCH				
PRICES per night from 12 noon till 12 am	Du 28/07 au 23/08 Très Haute saison	Du 07/07 au 27/07 Du 24/08 au 31/08 Haute saison	Du 14/04/ au 06/07 Du 01/09 au 28/09 Mi-saison	Du 01/01 au 13/04 du 29/09 au 31/12 Basse saison
Pitch + car	6,70	6,50	4,70	4,00
Person + 7 years	4,50	4,20	3,10	2,70
Person - 7 years	2,90	2,60	2,10	1,70
Electricity 5 A (1100w)	3,30	3,30	3,30	3,30
Electricity 10A (2200w)	5,00	5,00	5,00	5,00
Visitor	4,00	4,00	3,00	3,00
Animal	2,50	2,50	2,50	2,50
Extra car	2,50	2,50	2,00	2,00
Washing machine	4,50	4,50	4,50	4,50

Pitch: maximum 6 persons, one principal accommodation, a car, one small tent.

RENTALS				
From Saturday 4 pm till - Saturday 10 am				
This rate p/week includes: pitch, 1 car, gas, electricity, water				
PRICES per week For 5 persons	Du 28/07 au 23/08 Très Haute saison	Du 07/07 au 27/07 Du 24/08 au 31/08 Haute saison	Du 14/04/ au 06/07 Du 01/09 au 28/09 Mi-saison	Du 01/01 au 13/04 du 29/09 au 31/12 Basse saison
Mobil home B	570	520	400	300
Mobil home C	620	570	450	310
For 4 persons Mobil home A	550	500	380	270
Each extra person	20	20	20	30

No included in these prices: insurance, visitors, extra car

We cannot accept animals in rental accommodation

Since 4/1/2012: VISITOR'S TAX IN ADDITION: 0.30 € per anybody and day. Exemption for the children of less than 13 years, the handicapped people, large families, etc...

Other rentals rates per day

Baby bed, fridge : 2,50€

You only have to bring your own mattress-covers, sheets for all accommodation, and you add blankets and pillows for caravan.

Corner kitchen nook with fridge, 1 stove (3 gas burners), cutlery, crockery, pots and pans, cleaning equipment, garden table and chairs, sun umbrella.

MOBIL-HOME: middle living room, 2 independent bedrooms, shower and private toilets.

A: 21 m², 4/5 persons. 1 bed 140 cm + 2 beds 70 cm.

B: 21 m², 5 persons. 1 bed 140 cm + 2 beds 70 cm + 1 bunk bed in children bedroom.

C: 27 m², 6 persons. 1 bed 140 cm + 2 beds 80 cm. You can also make a double bed in central part.

A full inventory list will be supplies with our confirmation letter of your rental.

Only gas barbecues are permitted at the campsite. However, a communal barbecue is available for you to use

Model A and B (IRM Mercure 1999, 2000 and 2001)

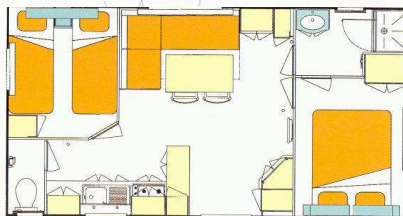

Model C (IRM Mercure 2001)

Payment: Credit card (€)

: Number:.....
: Date of validity: MM/YY.....
: Cryptogram:

: Your name:
: Address:
:
: Country, postal code;.....
: Accompanying persons(surname, first name, date of :birth)
:
:
: Telephone number:
: E-mail:.....
: Date of arrival:
: Date of departure:
: Car registration.....
: Animal:

PITCH

: For: caravan tent trailer-tent
: With electricity 5A No electricity
:
: : Amount of down payment.....€
: (50€ for rented week + administration fee: 10€)
: **The remainder is to be paid the day before your departure.**

RENTAL ACCOMMODATION

: Mobil home A B C
:
: Amount of down payment.....€
: (30% for rental week + administration fee: 10 €)
:
: **The remainder is to be paid at least 30 days before your arrival.**

: In case of non-payment of the remainder 30 days before your arrival, the heading "cancellation" will come into effect.

: How did you come by our address?.....
:
: I the undersigned, hereby declare to have read and accepted the conditions 2011 printed overleaf.

: Place & Date :.....
: Signature :